

REMINGTON®

Curl Revolution Styler



CI606

 www.remington.co.uk

Register online for an EXTRA year guarantee

Visit uk.remington-europe.com/product-registration You must register within 28 days of purchase.

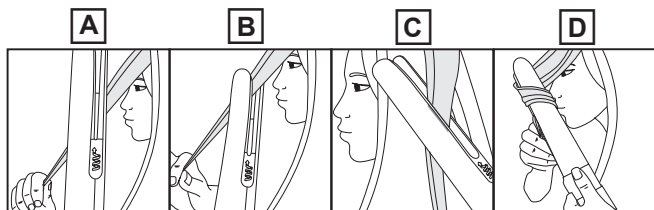
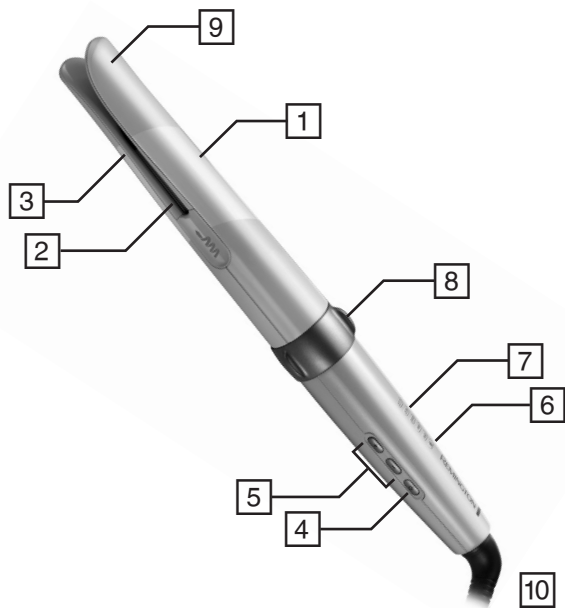

Thank you for buying your new Remington® product. Please read these instructions carefully and keep them safe. Remove all packaging before use.

WARNING: This appliance is hot. Keep out of reach of children at all times.

IMPORTANT SAFEGUARDS

- This appliance can be used by children aged from 8 years and above and persons with reduced physical, sensory or mental capabilities or lack of experience and knowledge if they have been supervised/instructed and understand the hazards involved. Children shall not play with the appliance. Cleaning and user maintenance shall not be done by children unless they are older than 8 and supervised. Keep the appliance and cable out of reach of children under 8 years.
 -  Do not use this appliance near bathtubs, showers, basins or other vessels containing water.
 - When the appliance is used in a bathroom, unplug it after use since the proximity of water presents a hazard even when the appliance is switched off.
 - For additional protection, the installation of a residual current device (RCD) having a rated residual operating current not exceeding 30 mA is advisable in the electrical circuit supplying the bathroom*.
- * Currently, the fitting in a bathroom of an electrical socket suitable or capable of operating the appliance is not permitted in the UK (see BS7671).
- Burn hazard. Keep the appliance out of reach from young children, particularly during use and while cooling down.
 - Never leave the appliance unattended when it is connected to the power supply.
 - Always place the appliance with its stand, if any, on a heat-resistant, stable flat surface.

- If the supply cord of this unit becomes damaged, discontinue use immediately and return the appliance to your nearest authorised Remington® service dealer for repair or replacement in order to avoid a hazard.
- Do not allow any part of the appliance touch the face, neck or scalp.
- Keep the power plug and cord away from heated surfaces.
- Do not use attachments other than those we supply.
- Do not use the appliance if it is damaged or malfunctions.
- Do not twist or kink the cable, or wrap it round the appliance. Check the cord regularly for any sign damage.
- This appliance is not intended for commercial or salon use.

PARTS

- | | |
|------------------------------|--------------------------------------|
| 1. Rotating Barrel | 7. Temperature display |
| 2. Opening in barrel | 8. 2-way rotation switch |
| 3. Shorter opening side | 9. Cool tip |
| 4. On-off switch | 10. Swivel cord |
| 5. Temperature controls | 11. Heat resistant pouch (not shown) |
| 6. Temperature lock function | |

ADDITIONAL FEATURES

- Fast heat up—ready to use in 15 seconds.
- Automatic safety shut off – this unit will switch itself off if no button is pressed or it is left on after 60 minutes.
- Multivoltage: for home or abroad. At 120V times and temperatures may vary.

INSTRUCTIONS FOR USE

- Before use, ensure the hair is clean, dry and tangle-free.
- For extra protection use a heat protection spray.
- Hairsprays contain flammable material – do not use while using this product.
- Section the hair prior to styling. Style the lower layers first.
- To ensure optimum performance please ensure that the sections of hair are clean without any stray or loose hairs.
- To achieve different curl sizes take different widths of sections. To enhance this also alter the temperature.

- See below for a guide on how to achieve different curl sizes but this will vary dependent on your hair type.

Curl Type	Hair Section Width	Temperature Setting
Tight Curls	1 cm	230°C
Medium Curls	3 cm	200°C
Loose Curls	5 cm	160°C

1. Plug the product into the mains power supply.
2. Press and hold the on button to switch on.
3. Start styling on lower temperatures first. Select appropriate temperature for your hair type using the controls on the side of the product.
4. To adjust the temperature use the +/- temperature controls on the side of the product. '+' increases the temperature '-' decreases the temperature.

Recommended Temperatures

Temperature	Hair type
160°C - 180°C	Thin / fine, damaged or bleached hair
200°C - 220°C	Normal, healthy hair
230°C	Thick and difficult to style hair

Caution: The hottest temperatures should only be used by experienced stylists.

5. The temperature display will stop flashing when the product is ready to use.
6. Holding the styler with one hand have the shorter opening side of the styler (indicated by ) at the top of the hair strand.
7. With the other hand hold the bottom of the of the hair strand taught. Fig A.
8. Slide a section of hair into the opening in the barrel. Fig B.
9. Keeping hold of the bottom of the strand of hair ensure the hair strand sits across the styler at a diagonal angle. The gloss area on the styler barrel provides a guide to the correct angle the hair needs to be fed into the styler. Fig C.
10. Still keeping hold of the bottom of the strand press the rotation switch in the direction you would like to curl the hair. Fig D.
11. Pressing the switch to the right will rotate the barrel clockwise.
12. Pressing the switch to the left will rotate the barrel anti clockwise.
13. Release the hair strand and hold the styler in place with the rotation switch activated while the hair strand is automatically fed into the opening and rotates up the barrel until it drops off the end.

14. Allow the hair to cool before styling.
15. Repeat this around the head to create as many curls as desired.
16. After use, press and hold the off button for 2 seconds to turn off then unplug the appliance.

Temperature Lock Function

- Set the desired temperature by pressing +/- buttons and lock the temperature controls by pressing the 'L' button for 2 seconds. The lock LED will illuminate.
- To unlock the temperature controls, press and hold the 'L' button again for 2 seconds.
- Let the appliance cool down before cleaning and storing away.

CLEANING AND MAINTENANCE

- Unplug the appliance and allow to cool.
- Wipe all the surfaces with a damp cloth.
- Don't use harsh or abrasive cleaning agents or solvents.

RECYCLING



To avoid environmental and health problems due to hazardous substances, appliances and rechargeable and non-rechargeable batteries marked with one of these symbols must not be disposed of with unsorted municipal waste. Always dispose of electrical and electronic products and, where applicable, rechargeable and non-rechargeable batteries, at an appropriate official recycling/ collection point.

SERVICE AND GUARANTEE



Defects affecting product functionality appearing within the guarantee period will be corrected by replacement or repair at our option provided the product is used and maintained in accordance with the instructions. Your statutory rights are not affected. To claim an extra 1 year guarantee, register your product online within 28 days of purchase.

Register at: <https://uk.remington-europe.com/product-registration>

Consumables are guaranteed only for their recommended lifecycle. Replacement/spare parts* are excluded and are only covered by a 1 year warranty.

*Examples include, but are not limited to, adaptors, haircare attachments, grooming accessories, etc.

SERVICE CENTRE

United Kingdom

 0800 212 438 (free call mainland UK)
Spectrum Brands (UK) Ltd
Fir Street, Failsworth, Manchester
M35 0HS, UK
www.remington.co.uk

Ireland

 142 951 40
Remington Consumer Products,
Unit B12, Ballymount Corporate Park,
Ballymount, Dublin 12
<https://ie.remington-europe.com>

Model No. CI606

19/UK/ CI606 T22-7000676 Version 02 /19

Remington® is a Registered Trade Mark of Spectrum Brands, Inc., or one of its subsidiaries.
Spectrum Brands (UK) Ltd

Fir Street,

Failsworth,

Manchester

M35 0HS

www.remington.co.uk

© 2019 Spectrum Brands, Inc.